

Barbie®

Instructions

Dream House®

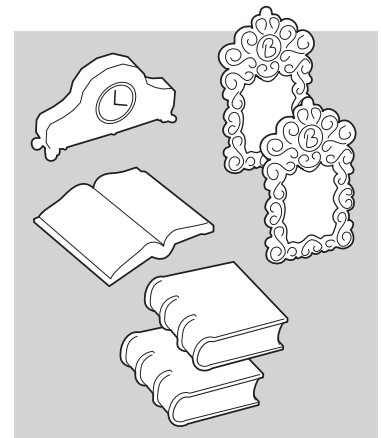
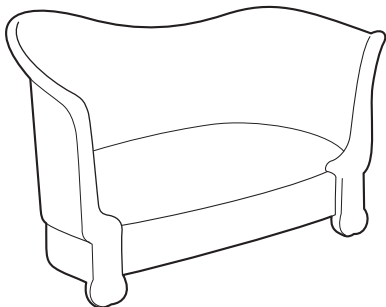
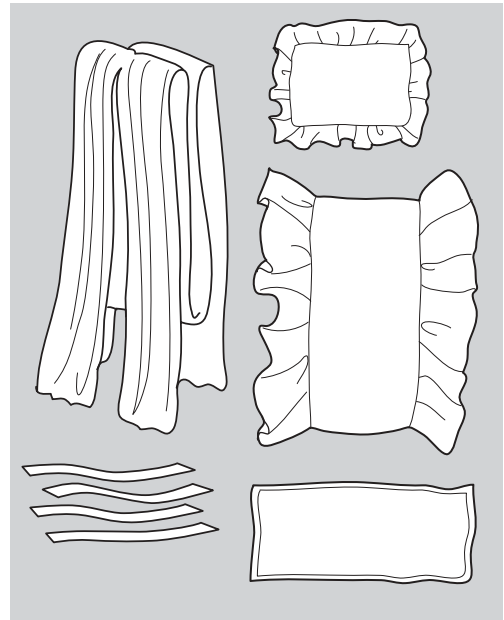

Colors and decorations may vary.

Please remove everything from the package and compare to the contents shown here.
If any items are missing, please call 1-800-524-TOYS.
Keep these instructions for future reference as they contain important information.

© 2003 Mattel, Inc., El Segundo, CA 90245 U.S.A. All Rights Reserved.

B5193-0920



Unfold Bed and Add Canopy

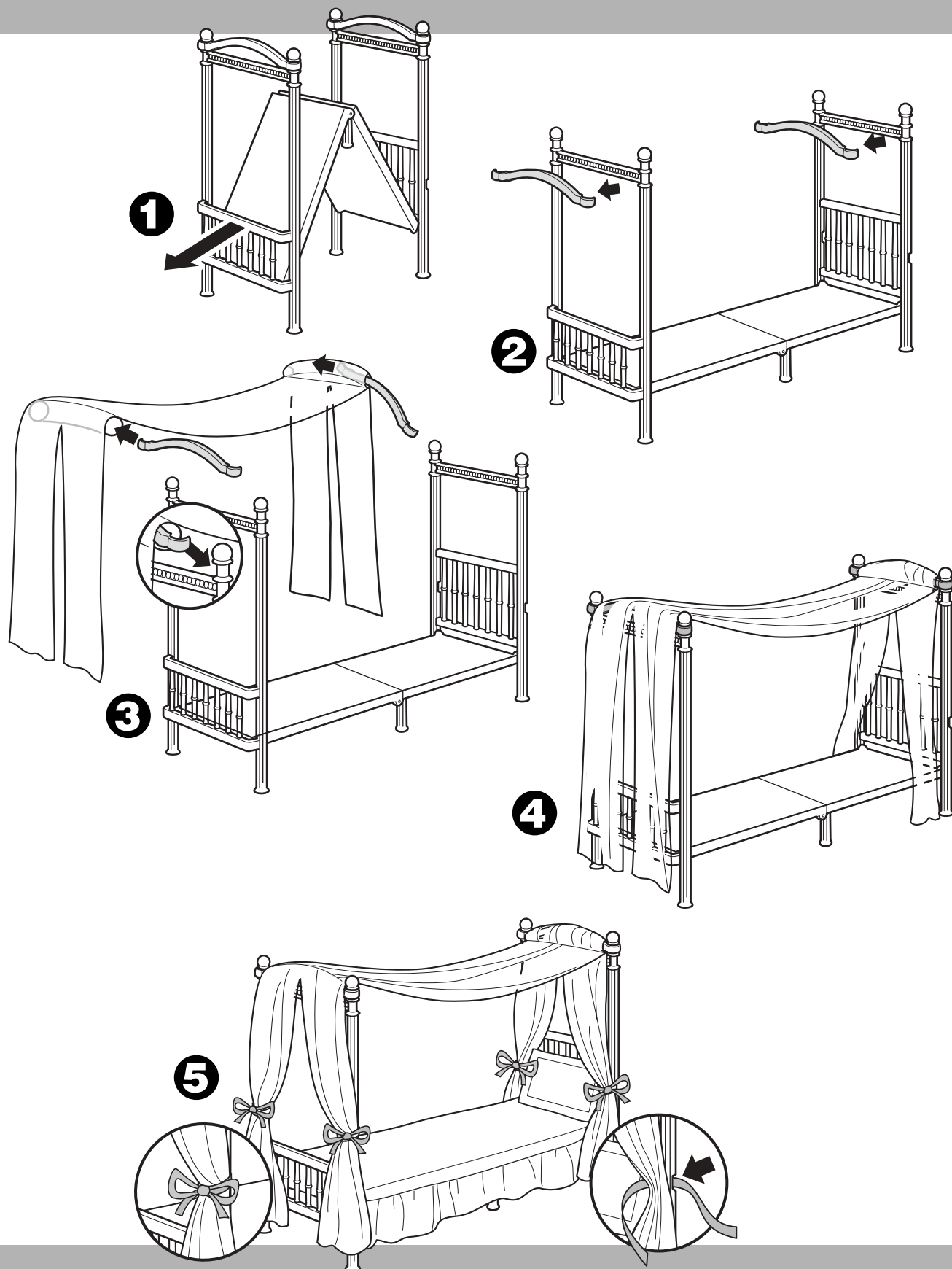

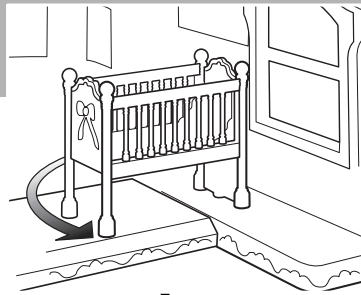

SEE "UNFOLD BED
AND ADD CANOPY"

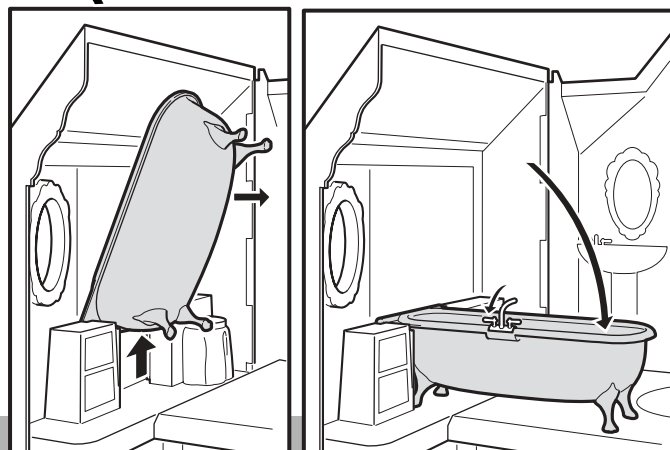
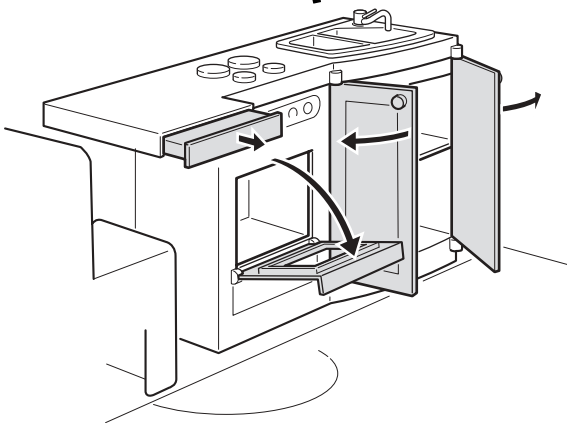
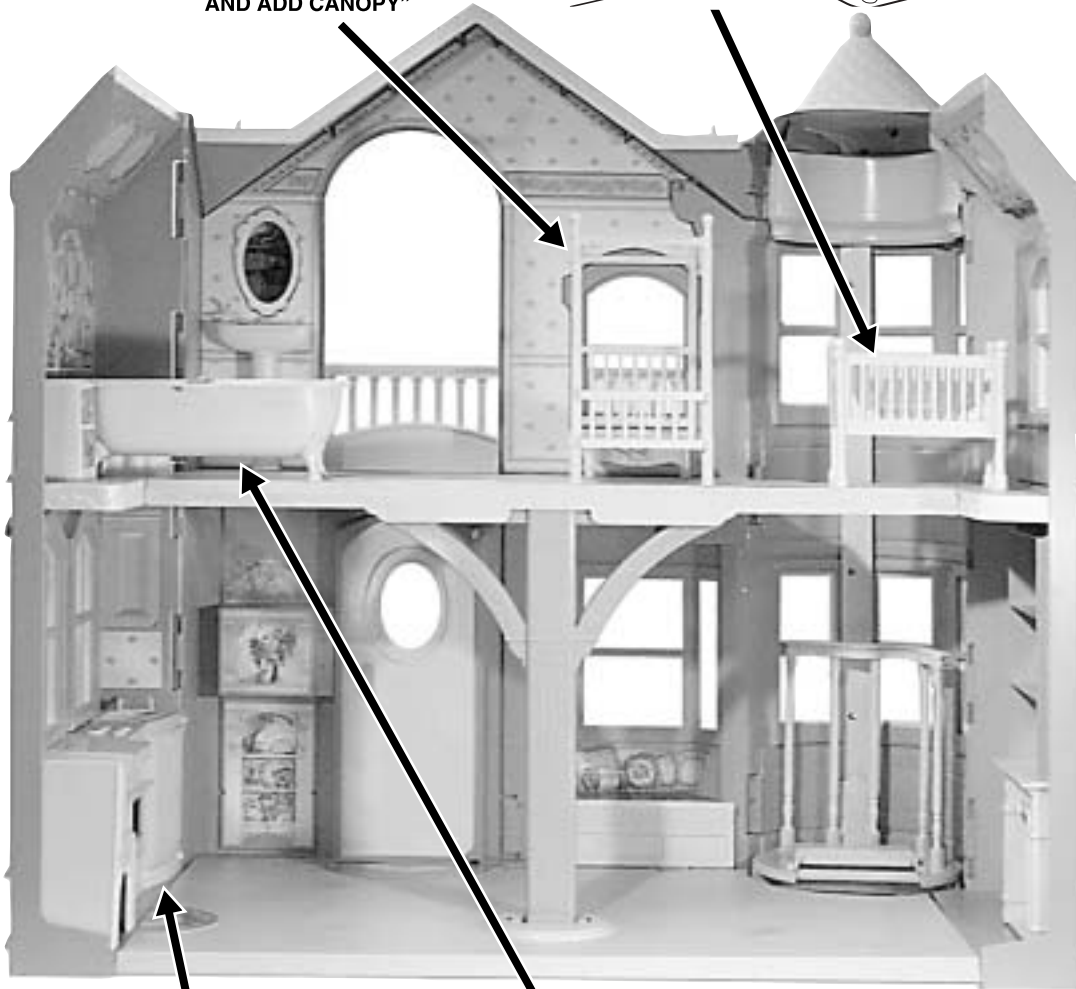

Raise and Lower Elevator

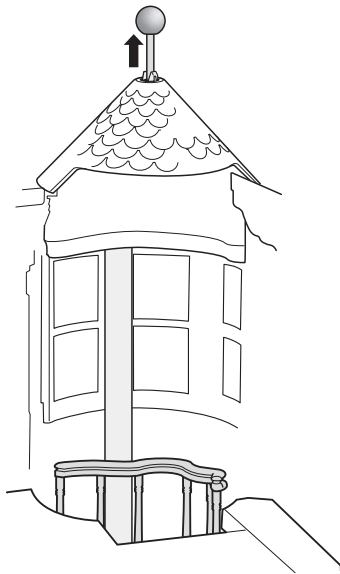

Raise handle.

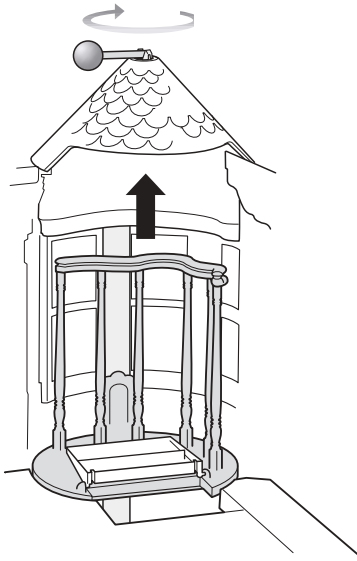

Turn handle to raise and lower elevator.



Swing ramp down and lower handle.

Storage

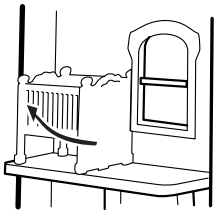

Swing crib back against wall.

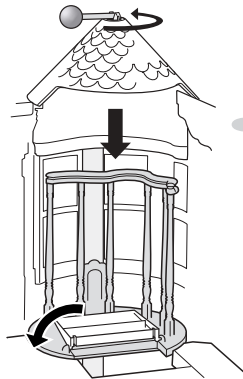

Close ramp, lower elevator and re-insert handle.

The elevator must be in the lowered position in order to fold up floors and to close the house.

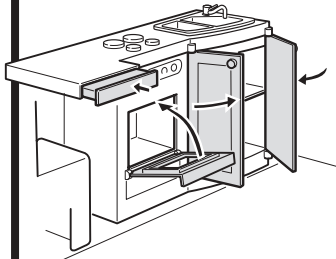

Shut kitchen doors.

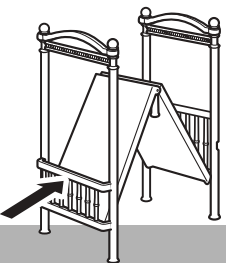

Fold up bed.

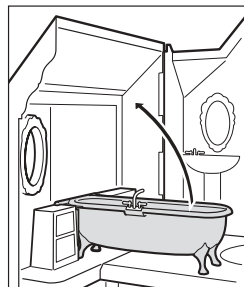

Fold tub up into wall.

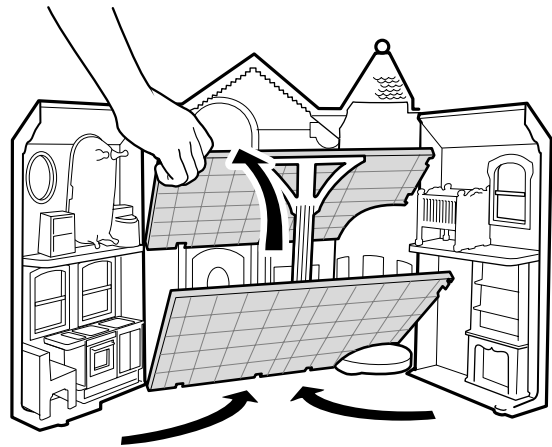

Fold up floors and sides.

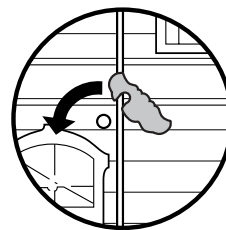

Close latch.

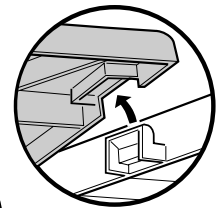

Unfold House

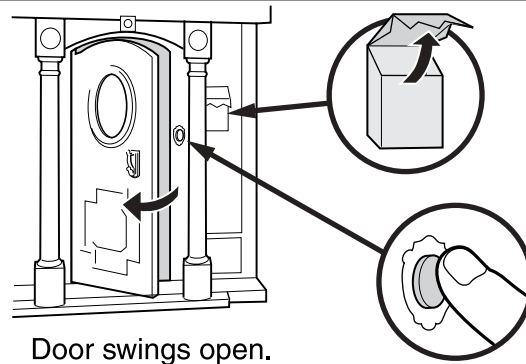
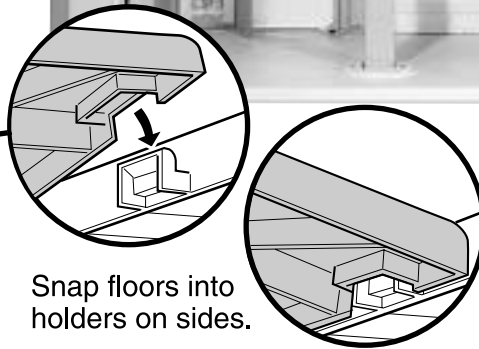
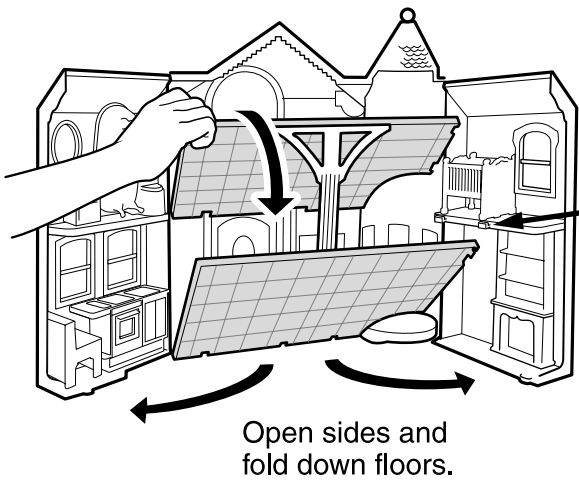
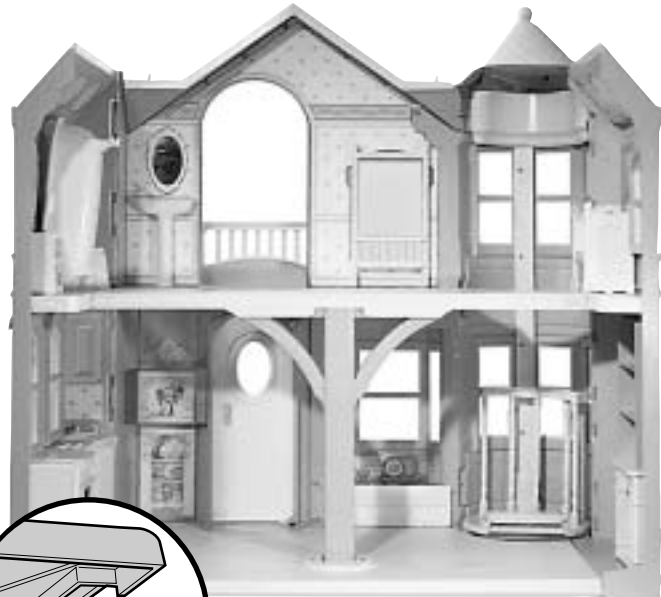
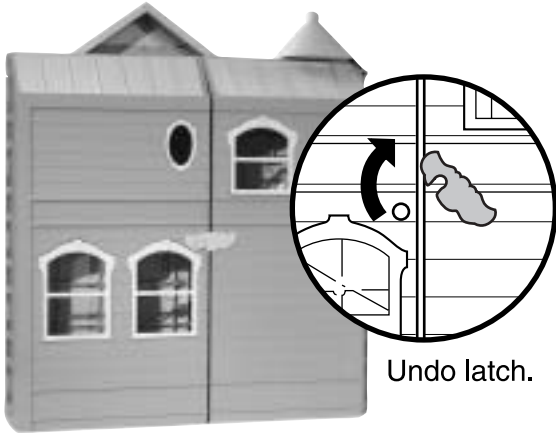

Welcome to the Dream House®.

2 YEAR LIMITED WARRANTY

Mattel, Inc. warrants to the original consumer purchaser that this product will be free of defects in material or workmanship for two years (unless specified in alternate warranties) from the date of purchase. If defective, return the product along with proof of the date of purchase, postage prepaid, to Consumer Relations, 636 Girard Avenue, East Aurora, New York 14052 for replacement or refund at our option. This warranty does not cover damage resulting from unauthorized modification, accident, misuse or abuse. In no event shall we be responsible for incidental, consequential, or contingent damages (except in those states that do not allow this exclusion or limitation). **Valid only in U.S.A.** This warranty gives you specific legal rights and you may also have other rights which vary from state to state. Some states do not allow the exclusion of incidental or consequential damages, so the above exclusions or limitations may not apply to you.

Send only the product to the address above. Send all correspondence to Consumer Relations, Mattel, Inc., 333 Continental Blvd., El Segundo, California 90245-5012 U.S.A. Or you may phone us toll-free at 1-800-524-TOYS, Monday – Friday, 8:00 a.m. – 6:00 p.m. Eastern Time. Outside U.S.A., see telephone directory for Mattel listing.

Mattel Canada Inc., Mississauga, Ontario L5R 3W2. You may call us free at 1-800-665-6288.

Mattel U.K. Ltd., Vanwall Business Park, Maidenhead SL6 4UB. Helpline 01628500303.

Mattel Australia Pty., Ltd., Richmond, Victoria. 3121. Consumer Advisory Service - 1300 135 312.

Mattel East Asia Ltd, Room 1106, South Tower, World Finance Centre,
Harbour City, Tsimshatsui, HK, China

Diimport & Diedarkan Oleh: Mattel SEA Ptd Ltd.(993532-P) Lot 13.5, 13th Floor, Menara Lien Hoe,
Persiaran Tropicana Golf Country Resort, 47410 PJ. Tel:03-78803817, Fax:03-78803867.

Mattel, Inc., El Segundo, CA 90245 U.S.A. Consumer Affairs 1 (800) 524-Toys.



CONSUMER INFORMATION	
MATTY MATTEL™ TOYS 	<p>YOU CAN TELL IT'S MATTEL!™ CALL us toll-free or write with any comments or questions about our products or service. Monday-Friday 8:00 a.m.-6:00 p.m. Eastern Time. Outside U.S.A., see telephone directory for Mattel listing.</p> <p>Consumer Relations, Mattel, Inc. 333 Continental Blvd. El Segundo, CA 90245 USA</p> <p>1(800)524-TOYS</p>
WE ARE DEDICATED TO QUALITY PRODUCTS.	