

3+

Barbie INSTRUCTIONS

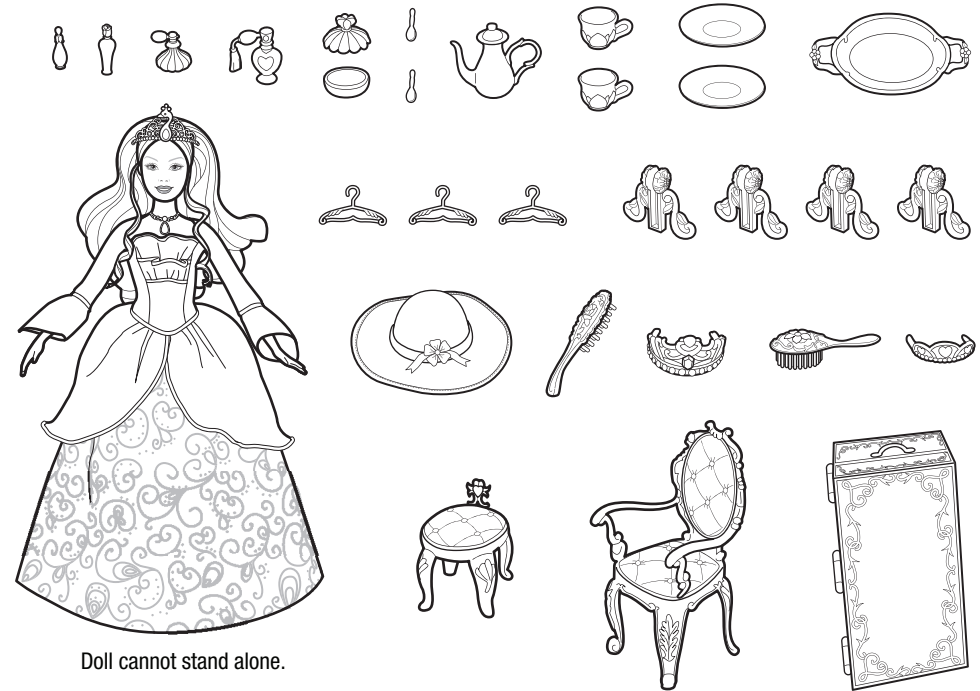

Doll cannot stand alone.

For U.S.A. market only:  
 We want you to have fun playing with our products.  
 Please give us your feedback by filling out the short on-line survey.  
 Go to :  
[service.mattel.com/surveys](http://service.mattel.com/surveys)  
 Thanks for helping us make great toys even better!

### CONSUMER INFORMATION

Need Assistance? Visit [service.mattel.com](http://service.mattel.com) or call 1-800-524-8697  
 (US and Canada only), M-F 9AM - 7PM & SAT 11AM - 5PM, Eastern.

[SERVICE.MATTEL.COM](http://SERVICE.MATTEL.COM)

Mattel Canada Inc., Mississauga, Ontario L5R 3W2. You may call us  
 free at/ Composez sans frais le 1-800-524-8697.

Mattel U.K. Ltd., Vanwall Business Park, Maidenhead SL6 4UB.

Mattel Australia Pty., Ltd., Richmond, Victoria. 3121. Consumer  
 Advisory Service - 1300 135 312.

Mattel East Asia Ltd., Room 1106, South Tower, World Finance Centre,  
 Harbour City, Tsimshatsui, HK, China.

Diimport & Diedarkan Oleh: Mattel SEA Ptd Ltd.(993532-P) Lot 13.5,  
 13th Floor, Menara Lien Hoe, Persiaran Tropicana Golf Country  
 Resort, 47410 P.J. Tel:03-78803817, Fax:03-78803867.

Mattel, Inc., 333 Continental Blvd., El Segundo, CA 90245 U.S.A.  
 Consumer Relations 1 (800) 524-8697.

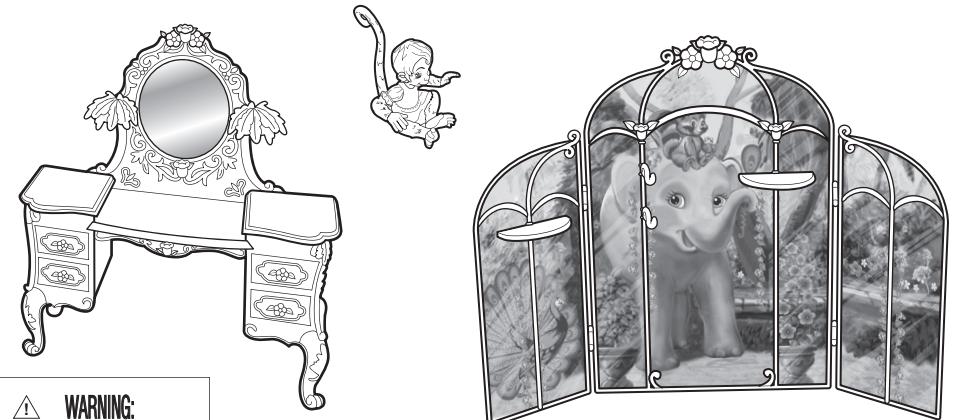

**WARNING:**  
**CHOKING HAZARD** - Small parts.  
 Not for children under 3 years.

**Contents:** Colours and decorations may vary from those shown.  
 Please remove everything from the package and compare to the contents shown here.  
 If any items are missing, please contact your local Mattel office.  
 Keep these instructions for future reference as they contain important information.

## Getting Ready

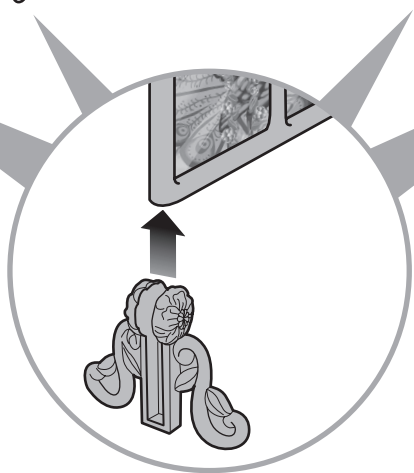
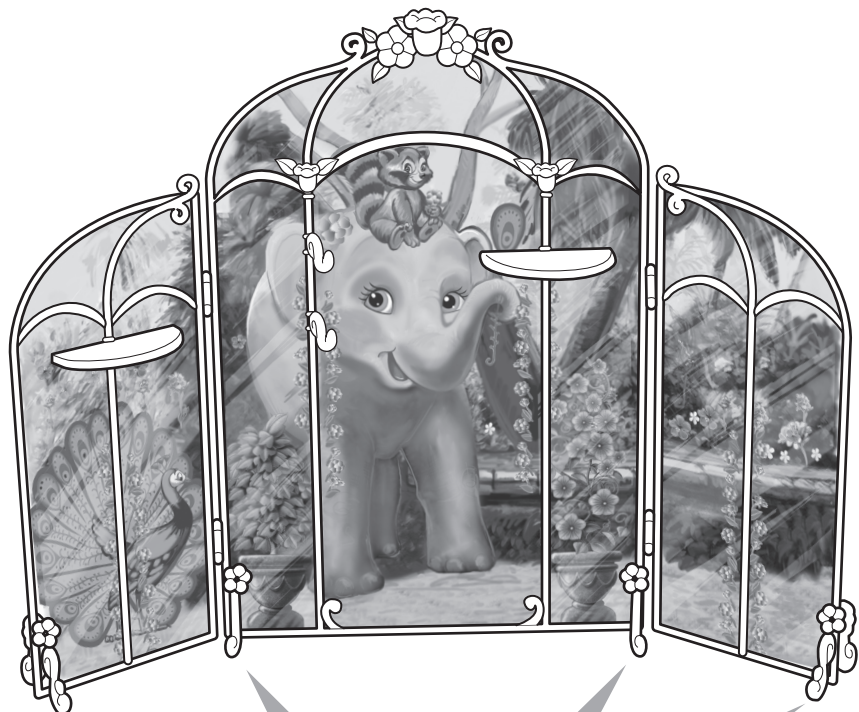

## Play Time!

