

Color cartridge in this product has been sealed with a tamper-evident seal. If this seal is broken, do not use this product and call Mattel Consumer Relations 1-800-524-8697 for a replacement.

Barbie

## INSTRUCTIONS



CFN48  
CFN49

5+

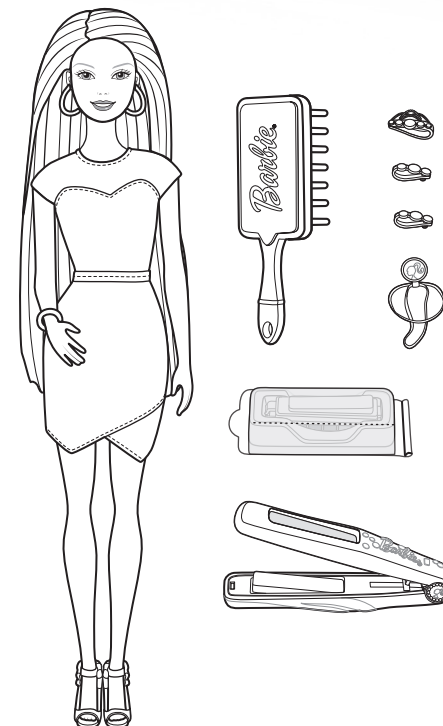

Doll cannot stand alone.

Protect play area before use. Color cartridge may stain fabrics and other surfaces. Avoid contact with carpet, clothing, walls and furniture.

Note: Hair color for use on doll only.

CFN48-1100146295G1-DOM

### CONSUMER INFORMATION

Need Assistance? Visit [service.mattel.com](http://service.mattel.com) or call 1-800-524-8697 (US and Canada only).

[SERVICE.MATTEL.COM](http://SERVICE.MATTEL.COM)

Mattel, Inc., 636 Girard Avenue, East Aurora, NY 14052, U.S.A. Consumer Services 1-800-524-8697.  
Mattel U.K. Ltd., Vanwall Business Park, Maidenhead SL6 4UB. Helpline 01628 500303.  
Mattel Australia Pty., Ltd., Richmond, Victoria. 3121. Consumer Advisory Service - 1300 135 312.  
Mattel East Asia Ltd., Room 503-09, North Tower, World Finance Centre, Harbour City, Tsimshatsui, HK, China.  
Diimport & Diedarkan Oleh: Mattel Southeast Asia Pte. Ltd., No 19-1, Tower 3 Avenue 7, Bangsar South City, No 8, Jalan Kerinchi, 59200 Kuala Lumpur, Malaysia. Tel: 03-78803817, Fax: 03-78803867.

 **WARNING:**  
CHOKING HAZARD - Small parts.  
Not for children under 3 years.

Please remove everything from the package and compare to the contents shown here. If any items are missing, please contact your local Mattel office. Keep these instructions for future reference as they contain important information.

©2014 Mattel. All Rights Reserved.

# Barbie

1

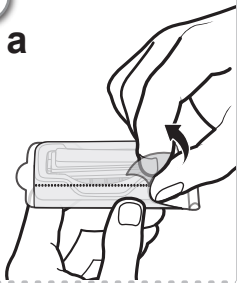

a

Remove tamper-evident seal.

b

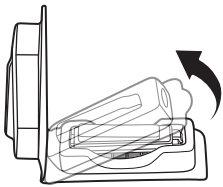

Remove color cartridge from the blister. Keep the blister for future storage of color cartridge.

2

a Remove cardboard insert from hair tool before use.

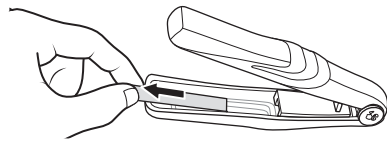

b Insert color cartridge into the tool.

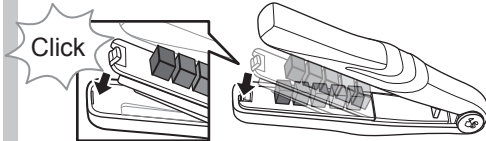
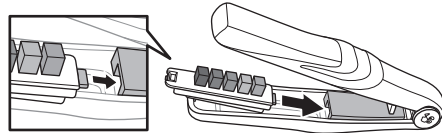

5

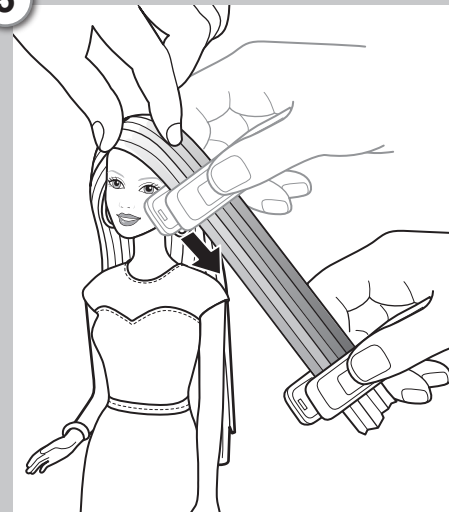

Slide the tool down the hair. Apply hair color several times to get brighter color.

6

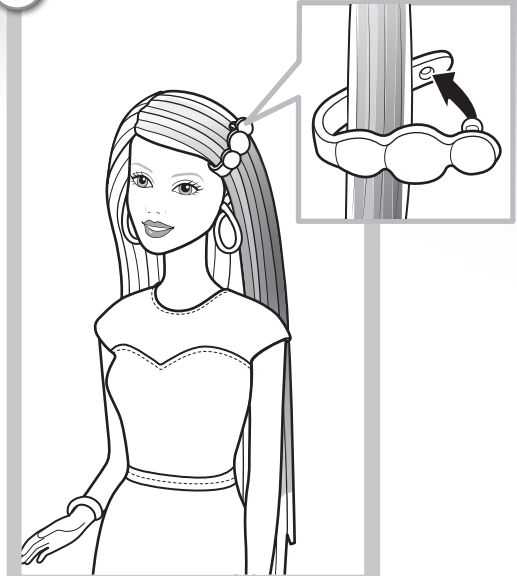

3



a

Brush hair and select a portion of hair.

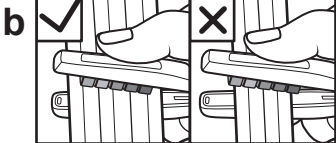

b

The hair should be slightly wider than the hair color (1.5" or 4cm).

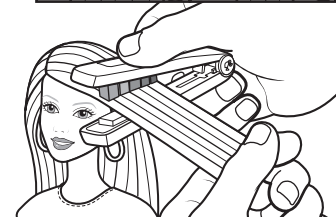

4

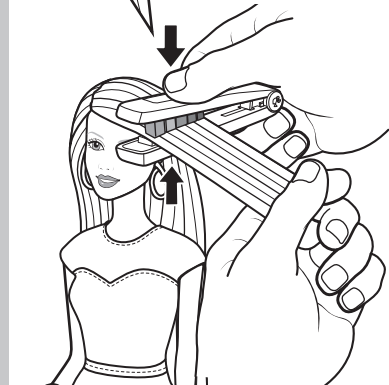
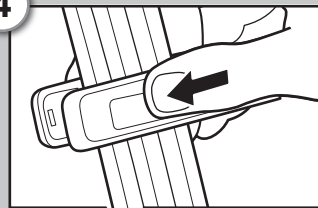

Close the tool over hair and apply pressure as shown.

Note: Once play has been completed, remove the color cartridge and place within the reusable blister to delay drying and prevent contamination while not in use.

a

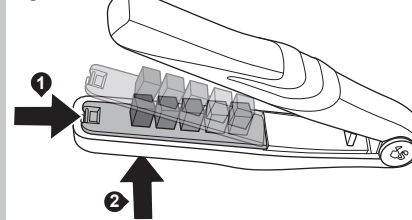

b

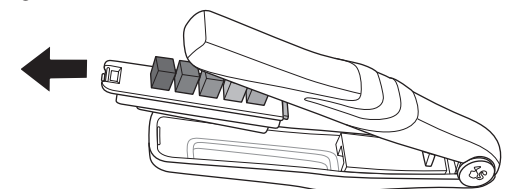

Release the clip and push color cartridge out from the tool.

Tip:

Wash hair color off with warm water and soap (not included) for best removal. Drain/rinse/clean/dry all items thoroughly before storing.